



TMS E-News - 11/2/18

**In the afternoon, please use the parking spots to wait for your student.
DO NOT park along the curb as this blocks the flow of traffic.
PLEASE DO NOT use the entrance as an exit!**

Nov. 5 - First meeting of the woodworking club - 2:45-4:00 pm

Nov. 6 - Election Day No School for Students/Staff Professional Development

Nov. 6 - Winter Sports Parent Meeting - TMS Cafeteria @ 6:00 pm

Nov. 8 - 7th & 8th Grade Choir Concerts - THS @ 7:00 pm (see below)

Nov. 9 - End of First Trimester

Order Your Yearbook Today: ybpay.lifetouch.com

Order Deadline: 12/07/18

Yearbook ID Code: 10975619

Yearbooks can be ordered online, or there are order forms in the office. Checks made payable to Lifetouch. Be sure to use the ID Code above.

Parents: Primary Health Solutions Mobile Dental Program will be starting up again this month. If interested, please contact Terri Horvath RN at #273-3314 for additional information. This is a great program!

Parents / Guardians,

The 7th and 8th grade choirs have been working very hard this fall! We are excited to present our work on Thursday, November 8, at Talawanda High School, 7 p.m. Students need to be present for warm-ups and attendance at 6:30 p.m. This concert serves as an exam grade for choir. Attendance is required. Please contact me if you need assistance in making transportation arrangements. I am happy to connect students for ride sharing. Questions or concerns may be sent to: casek@talawanda.org See you on Monday!

Concert attire: Black on bottom, white on top. Black shoes and socks/stockings. All clothing should be school appropriate.

Thank you!

Kelly Case

TMS Choir Director

**** ATTENTION ****

**The Pie Sale ends next week. . .
November 7, 2018.**

You are welcome to turn in your order form & money anytime before Wednesday, November 7th.

- **There is no school on Tuesday, November 6th.**
- **If your child is absent Wednesday. . . I will still need the order form to call in the number of pies we need.**
- **You can call or email Mr. Brinck if you can't get the order form to TMS on Wednesday 11-7-18.**

Email - brinckj@talawanda.org

Cell - 513-477-9503

REMEMBER -- to include the following with your order form

- 1- YOUR NAME + Grade - have to give credit to someone.**
- 2- All checks are payable to TMS PTG.**
- 3- Please place your order + money in a ziploc bag or envelope so it stays in together in one place.**

-Any student that carries an inhaler or epipen at school must have a medication permit on file in the clinic.

-Parents of 7th Graders - If you have not already done so, please send in proof of your child having received the tdap and meningitis immunization.

Please call Terri Horvath RN at 273-3314 with any questions. Thank you.

Any 5th - 8th-Grader who has completed an act of volunteerism and would like to be considered for a \$1000 cash is encouraged to apply for the Prudential Spirit of Community Award. The application can be found online at spirit.prudential.com and is due by November 6th. Talawanda will have one local winner (grades 5-8) who will be considered for the State Award, \$1000, and a trip for themselves and a parent/guardian to Washington, DC this spring for a 4-day recognition ceremony.



Woodworking club will begin Monday, November 5th. It is limited to 12 8th graders and we will meet every other Monday after school until 4pm. Signups will be during lunch on Monday, October 15th. If you have any questions, please contact Larry Brock at BrockL@talawanda.org

TALAWANDA DANCE TEAM

2018 – 2019



BE A PART OF THE 1ST TALAWANDA MIDDLE SCHOOL DANCE TEAM!
The team will be open to 6th, 7th, and 8th graders and will perform at Boy's HOME Basketball games. Information packets will be available in the Middle School office starting October 29, 2018.

Clinic Dates

Tuesday, November 13th ~ 3-4:30pm
Wednesday, November 14th ~ 2:15-4pm

1st Practice will be Thursday, November 15th!

We will be taking up to 12 athletes for the team. Selections will be made at the end of the clinic November 14th.

If you have questions please contact Janna Eason, easonj@talawanda.org.

**** All paperwork must be turned in by November 12, 2018****

TMS PTG PIE SALE -- To Support Class Sponsored Field Trips

OCTOBER 17 - NOVEMBER 7, 2018

Pie Pick up date -- November 19 in TMS Cafe starting at 2:50pm

Parents & Students,

Each year TMS PTG offers two fundraisers. Every student is welcome to participate. The fundraisers are set up so that students have the opportunity to earn money to help pay the cost of class trips offered in the 6th, 7th, and 8th grade.

- 6th Grade = The Glen Helen Experience, cost @ \$145.00.
- 7th Grade = Columbus Zoo & COSI, cost @ \$20.00 - 30.00.
- 8th Grade = Washington, D.C. , cost @ \$575.00.

For the Pie Sale each student will keep 50% of what they sell. It will be placed into their TMS PTG account. That money may be used to pay for any school sponsored "class trip". Unused money will be donated to the TMS PTG Scholarship Fund.

Please read the PTG Fundraising Policy (attached) for more information.

PIE SALE INSTRUCTIONS. . . .

- Make sure the **STUDENT'S NAME + GRADE** is on the order sheet - written neatly!

- **ALL PIES COST \$14.00** except the **PECAN PIE is \$15.00.**

- Collect money at time of sale. All money must be turned in with the order sheet.
 - All checks are payable to TMS PTG.
- Place order sheet and money in an envelope or zip-lock bag.
 - Turn into the main office or Mr. Brinck.

Note: This fundraiser is voluntary. You are not required to participate.

Any questions or concerns about this sale or fundraising in general should be directed to John Brinck. Email = brinckj@talawanda.org Cell 513-477-9503.

ORGANIZATION: _____
 ORGANIZATION: _____
Order Must Be Placed By: _____
 Delivery Date To Your Organization: _____

ORGANIZATION: _____
 ORGANIZATION: _____
Order Must Be Placed By: _____
 Delivery Date To Your Organization: _____

[illegible]



We Appreciate Your Support



In supporting this fund-raising effort, you are receiving a delicious classic dessert, made from scratch using only the freshest ingredients, just like homemade. Pie Peddler products are fresh baked, never frozen, and ready to eat when you receive them.

Pies are 9" in diameter - Please indicate your selections on the reverse side of this form



Apple; a flaky crusted delight, this is like Grandma made, an American standard.



Dutch Apple; all the flavor of our traditional apple pie but with a lattice top crust. To this we add brown sugar and special dutch crumbs topped off with a cinnamon glaze.



Cherry; only the juiciest, tree ripened cherries are selected for this classic dessert. This double crusted beauty is a true legendary confection.



Blueberry; a berry lover's dream, loaded with succulent wild blueberries sandwiched between our famous melt in your mouth crusts.



Lemon Meringue; we use real Florida Lemon Juice to add just the right amount of mouth watering citrus flavor to this all time favorite.



Peach; we start with the luscious flavor of fresh from the tree peaches then steam cook to bring out the full rich flavor. The filling is placed into our hand made crust and baked to a golden brown.



Pecan; this is one of our signature flavors. *Only the best quality pecans are chosen* for this delicacy, a true southern favorite.



Chocolate Cream; our rich, smooth, creamy chocolate filling is topped by a whipped meringue, then chocolate sprinkles are added to make this a hometown favorite.



Coconut Cream; a coconut lover's dream. We add real coconut to our creamy filling and top with meringue. We finish it by sprinkling the top with even more toasted coconut and bake until golden brown.

Pie Peddler Confections Menu



Oxford PARKS & RECREATION

Paint the Turkey Paintball Outing!

You won't want to miss out on this exciting day of fun-filled paintball action!! Join us for our annual Paint the Turkey Paintball Outing on Saturday, November 3rd. Transportation will be provided by OPRD to the first 10 ten participants who sign up; all participants must arrive at the TRI by 9:15am. Participants who plan to meet us there must arrive at Cabin Creek by 9:30am and be picked up by 12:45pm. All participants should bring a non-refrigerated sack lunch to eat after the games; we will arrive back at the TRI at 1:00pm.

- All skill levels welcome.
- Games will be refereed and supervised at all times.
- Participants may bring own equipment. (Only semi-automatic guns will be permitted)

Who: Grades 6th-12th (Parents are welcome too!)

When: Saturday, November 3rd (9:15am- 1:00pm)

Where: Cabin Creek Paintball— 4117 Eaton Rd. Hamilton, OH 45013

Cost: \$30 R / \$33 NR (includes gun, mask, CO2 & paintballs)

Registration: Register by October 29th

In person: Oxford Parks and Rec Dept. (6025 Fairfield Rd.)

Online: www.cityofoxford.org/OPRD —> Programs



TSD APPROVED
for distribution
not affiliated with TSD



***All participants must register with OPRD to be part of the group outing.**



All proceeds benefit the Talawanda Track & Field and Cross Country programs.

Oxford Empty Bowls

A benefit soup luncheon dedicated to hungry people in our community

*Held in conjunction with Hunger + Homelessness Awareness Week and
the City of Oxford/Talawanda Schools/Miami University's Veterans Appreciation Day*



Saturday, November 10, 2018

11:00 a.m. – 2:00 p.m.

❖ **Oxford Community Arts Center** ❖

Purpose: To join other Empty Bowls projects worldwide to raise awareness and money to combat hunger. All proceeds will be donated to the Oxford Community Choice Pantry and other area organizations to support their efforts to provide food to local people in need.

How it Works: At the luncheon, guests choose from amongst a collection of beautiful bowls created, decorated and donated by Miami University and Talawanda students and Oxford-area potters. Their bowls are then filled with their choice of soups made by local cooks. Luncheon guests then keep their bowls to use or display at home and to serve as a reminder that there are always empty bowls in the world. Homemade bread and desserts, and beverages donated by area businesses will also be served.

Cost: \$10 adults; children 10 and under may eat for free (bowl not included).

For more information on Oxford Empty Bowls, please contact Connie Malone, 513-330-1273

Co-sponsored by the Office of Community Engagement & Service, Miami University

ADVANCED INQUIRY PROGRAM

IGNITE ECOLOGICAL & SOCIAL CHANGE

Chicago

CZS/Brookfield Zoo

Cincinnati

Cincinnati Zoo & Botanical Garden

Cleveland

Cleveland Metroparks Zoo

Denver

Denver Zoo

New York

WCS/Bronx Zoo

San Diego

San Diego Zoo Global

Seattle

Woodland Park Zoo

St. Louis

Missouri Botanical Garden

**APPLY BY
FEB 28TH**

Study at a Master Institution; Earn your degree from Miami University!

Photo: Golden lion tamarin, a species brought from the brink of extinction by zoos, scientists, governments, and communities working together.

TSU APPROVES
for distribution
not affiliate

AIP

MASTER'S

ADVANCED INQUIRY
PROGRAM

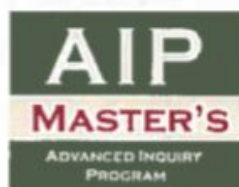

Apply at AIP.MiamiOH.edu

ISD AFFILIATE
for distri.
not affiliated



THE AIP MASTER'S DIFFERENCE

The Advanced Inquiry Program (AIP) offers a ground-breaking master's degree that combines web-based graduate courses through Miami University with face-to-face experiential learning and field study at premiere community learning institutions nationwide. AIP students learn with peers and faculty nationally while also working directly through their local AIP Master Institution to improve their communities through shared investigation and action.

OUR AIP MASTER INSTITUTIONS

- ★ Chicago Zoological Society/Brookfield Zoo – Chicago
- ★ Cincinnati Zoo & Botanical Garden – Cincinnati
- ★ Cleveland Metroparks Zoo – Cleveland
- ★ Denver Zoo – Denver
- ★ Missouri Botanical Garden – St. Louis
- ★ San Diego Zoo Global – San Diego
- ★ Wildlife Conservation Society/Bronx Zoo – New York
- ★ Woodland Park Zoo – Seattle

SAMPLE GRADUATE COURSES

AIP master's students earn 35 total credit hours: 21 credit hours of courses that combine web-based instruction with the excitement of experiential learning and field study on-site at your AIP Master Institution + 14 credit hours of AIP core courses that occur on the web.

- Foundations of Inquiry
- Conservation Science & Community
- Urban Ecology
- Global Biomes
- Project Design & Assessment
- Issues in Evolution
- Biology in the Age of Technology
- Graduate Research: Conservation Innovation

AIP students also have the option to integrate international field study into their coursework by participating in an Earth Expeditions course in Africa, Asia, Australia, or the Americas (7 credits from Earth Expeditions courses can count toward the AIP master's degree).

PROJECT DRAGONFLY AND THE AIP

Project Dragonfly reaches millions of people each year through Inquiry-driven learning media, public exhibits, and graduate programs worldwide.

Project Dragonfly is based in the biology department at Miami University in Oxford, Ohio. Established as a state university in 1809, Miami is one of the eight original Public Ivies and has a distinguished record of excellence in research and teaching in science and science education.



Advanced Inquiry Program Details

Why Participate?

The AIP is based on the principle that education should extend beyond the classroom, and that students should make a difference—not just after graduation, but now, as a basic function of education itself. AIP students join a coalition of extraordinary educators and conservationists to improve neighborhoods, schools, businesses, and ecosystems, while advancing national education standards through research-based practices.

The AIP master's can be completed part-time while working. It's designed for educators and a broad range of professionals from non-profit, business, and government settings.

Who Is Eligible?

Enrollment is open to applicants who hold a bachelor's degree—regardless of academic major or profession—and who are able to travel to an AIP Master Institution. Coursework occurs online with experiential learning at affiliated institutions.

Degree Options

Applicants elect to enroll in either a Master of Arts in Teaching (MAT) in the Biological Sciences or a Master of Arts (MA) in Biology. MA and MAT candidates go through the Advanced Inquiry Program together.

Miami University is fully accredited by the Higher Learning Commission of the North Central Association of Colleges and Schools (please see <http://miamioh.edu/academic-affairs/accreditation/>).

Costs

To support involvement by a broad range of educators and conservation professionals nationally, Miami University offers significantly reduced tuition for all classes in pursuit of the web-based AIP degree.

Applying Online Is Easy!

Apply at AIP.MiamiOH.edu by February 28.

Master's program applicants will also apply to Miami University's Graduate School; best to start this process as early as possible.





Talawanda School District
131 W. Chestnut St.
Oxford, Ohio 45056

TALAWANDA SCHOOL DISTRICT



EMERGENCY GUIDE

Talawanda School District
Ed Theroux, Superintendent



In the Talawanda School District, safe and secure learning environments are the first priority:
Students must first feel safe in order to grow academically, socially, and emotionally.

It is important to communicate actions that ensure safe school environments. Every emergency situation is unique in initiation and response so the information in this material is not all inclusive. However, it is intended to provide a better understanding of responses in the event of a crisis or emergency.



EMERGENCY GUIDE

TALAWANDA SCHOOL DISTRICT

TIP LINE:
844-SAFEROH

Through partnerships with the Ohio Department of Education and the Ohio Department of Public Safety, every school in Ohio has been registered for SaferOH, a tip line that proactively helps to ensure the safety and well-being of its students.

By calling **1 (844) SAFEROH**, students and adults can share information with district and law enforcement officials regarding threats to school or student safety, such as bullying, suicides, or violence.

Callers may remain anonymous or share their contact information for possible follow-up. The line will accept both calls and texts 24 hours a day, 7 days a week.

LIKE.

Web: www.talawanda.org

FOLLOW.

Twitter: @Talawanda

SHARE.

Facebook: [facebook.com/Talawanda School District](https://facebook.com/TalawandaSchoolDistrict)



An emergency is any unexpected incident that could affect the health or safety of students or employees

... such as a disruption in utilities or a national emergency. Emergencies can affect one child, one school, or the entire school district.

When an emergency occurs, school officials evaluate the seriousness of the situation and determine the best plan of action to respond quickly, safely, and appropriately. Emergency responders such as police, fire, and medical teams are notified and assist as needed.

EMERGENCY RESPONSE

Each Ohio school district has an emergency preparedness plan outlining possible scenarios and responses that vary based on conditions and situations.

The crisis management team, a team in each school that has emergency training, determines the best crisis response. In the event that the response includes an emergency student dismissal, it is important for parents to understand that students will be dismissed to parents once danger has passed.

In any emergency situation it is critically important that school leaders and safety personnel respond quickly. According to law enforcement and safety officials, it is important that parents wait for a call to pick up their children rather than rush to a site. Parents of students in the affected building will receive detailed information as soon as possible.

FOUR COMMON RESPONSE OPTIONS

LOCKDOWN

1 A lockdown may be used in response to an event inside or outside of a building. During a lockdown, students are restricted to their classroom and are not released from the classroom until lockdown procedures have concluded.

SHELTER-IN-PLACE

2 This protective action is enacted when an event takes place outside of the building and officials determine that the safest course of action is to keep students and staff inside the building until the external event is resolved. During shelter-in-place, there could be student movement within the building, but students will not be released from the building until the shelter-in-place procedures have concluded.

EVACUATION

3 If it is unsafe for students and staff to remain inside the building, the building will be evacuated. Students and staff may remain on school grounds until the building is safe to re-enter or may be relocated to a safe location off of school property, depending on a variety of circumstances.

EMERGENCY SCHOOL CLOSING

4 This procedure will take place if your school officials determine students are safer at home than at school or trying to get to school. This most often occurs due to loss of utilities or a weather emergency.

If your school or school district intends to send students home or evacuate from a risky location to safe location, specific information will be communicated to the parents of affected students through a phone call.

RESPONSE TO ACTIVE AGGRESSOR

In Ohio school districts, students and staff in all buildings are trained three times each year in an emergency response process known as ALICE. Most often used in the event of an active aggressor, ALICE empowers students and teachers to ensure their personal safety.

It is important to remember that ALICE is not a linear progression and response action, but is dependent on the individual situation. Decisions are made by teachers and students to ensure their personal safety.

A **ALERT:** Alert students and staff of an active aggressor.

L **LOCKDOWN:** Barricade a locked door with large objects, such as desks, chairs, shelves, etc.

I **INFORM:** Listen for communication, make informed decisions as to what action should be taken.

C **COUNTER:** If confronted by an aggressor, attempt to distract or confuse in order to get away.

E **EVACUATE:** Leave the area if it is unsafe based on all available information and observations.

Student Release Student-Parent Reunification

In the event of an emergency situation during which a parent chooses to remove his/her child from school, or one that requires students to go home, your school district will care for each student until a parent arrives or until it is safe to transport the student home using district school transportation. Be assured that no child will be left alone.

In a **situational student release**, school officials determine that students and staff members need to evacuate a building temporarily but DO NOT need to close school

or dismiss students. Parents who elect to remove students during the time of an evacuation will need to report to a designated area with photo ID to sign out students. Emergency contacts designated for student release by parents may also remove specific students from school with a photo ID. For safety reasons, no other individuals are permitted to take students from a school.

Reunification occurs when school officials determine that students and staff members need to evacuate a building, close school, and dismiss students. The closing of school may require that the students be relocated to a secondary location. If students are relocated to an off-campus reunification site, a "gated reunification system" will be in place. Parents of emergency contacts will be required to pick up students either on campus or from the secondary reunification location.

In the event of an **evacuation to another location**, Parents of students in the affected building will receive a phone call with detailed information. Evacuation locations are not made public in advance so as not to jeopardize the efficiency or safety of the plan.

Gated Reunification System

Students may only be released to a parent or emergency contact designated for student release. Photo identification is required.

Upon arrival at the reunification site, parents will:

1. Report to the parent check-in area;
2. Complete a reunification card;
3. Be escorted by a staff member to his/her child; and
4. Sign the reunification card to ensure all students are accounted for and safe.

Crisis Response Team

Your district personnel are trained using the **Traumatic Event Crisis Intervention Plan**. TECIP is a school-based framework designed to meet the emotional and psychological needs of students and staff in the aftermath of a traumatic event.

SAMPLE REUNIFICATION SCENARIO

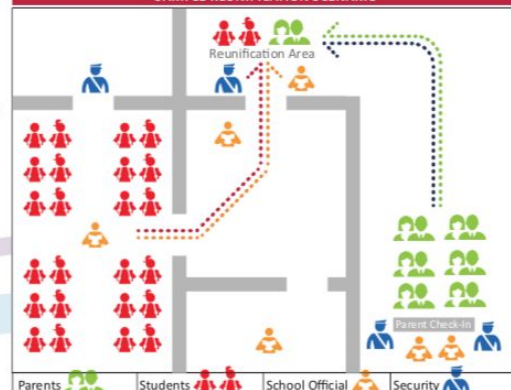

Attention Talawanda Middle School Families!

Save your Plastic Caps and Lids!

Please start saving your plastic caps and lids! The National Junior Honor Society (NJHS) is leading a bottle cap and plastic lid recycling initiative at TMS. The recycled bottle caps and lids will be collected until we have enough to **make a bench for TMS made completely of recycled lid and cap plastic** material we have collected!

Here is how you can help us:

- **Collect plastic bottle caps and plastic lids** (see list of acceptable caps and lids below)
- Feel free to collect large amounts at home and bring to school in grocery bags or ziploc bags - the whole bag can be placed in the collection bin
- **Please rinse** all lids and caps before bringing them to school
- Place lids and caps in a **collection bin** - there is one located in each grade level hallway and one in the cafeteria
- Collection will continue until we have enough to build a bench for TMS (Kramer and Marshall already have benches and Bogan is collecting this year for a bench!)
- Spread the word! Tell your friends, family, and neighbors and ask them to collect too!
- This benefits our community (recycling!), the school (we get a bench!), and you (you help make TMS a better place!)
- Questions? Contact NJHS Advisor Mrs. Murray murraym@talawanda.org

NJHS students will be responsible for collecting, cleaning, and sorting lids and caps here at school. This project is possible through the ABC Promise Partnership program at Green Tree Plastics, LLC. We appreciate your help in this project that promotes recycling and will benefit our school with a new bench!

ACCEPTABLE CAPS

medicine bottle caps	drink bottle caps
milk jug caps	flip-top caps (ketchup, mustard)
detergent caps	spout caps (mustard)
hair spray caps	spray paint caps
toothpaste tube caps	ointment tube caps
deodorant caps	caps w/ RECYCLE NUMBERS of (2) (4) (5)

ACCEPTABLE LIDS

cottage cheese container lids	cool whip container lids
mayonnaise jar lids	coffee can lids
yogurt lids	cream cheese container lids
peanut butter jar lids	butter container lids
ice cream bucket lids under 8"	Prescription bottles labels removed

TMS Clubs!!!

Please also visit our TMS web page to view clubs.

Yearbook Club

Plan, design yearbook

Advisors: Sharon Oberschlake and Suzanne Burch

oberschlakes@talawanda.org

burchs@talawanda.org

TMS Garden Club

We are building a new TMS garden to learn about where our food comes from, how to grow it in the most environmentally responsible way possible, and eventually share what we grow with the cafeteria salad bar or the Oxford Food Pantry. We will have our science classes test our soil, the STEAM club is helping build what we need, and we will research what grows best in our seasonal climate. We will have guest speakers in the winter including botanists, members of Miami's Slow Food Initiative, and various others.

Advisors: Amy Clay and Lindsay Krause

claya@talawanda.org

krausel@talawanda.org

Math Club

6th graders

Miami University tutors every Thursday after school to help students with the math content, common misconceptions and preparation. We currently have 46 students and about 14 Miami students participating.

Advisors: Don Gloeckner and Tammi Waite

gloecknerd@talawanda.org

waitet@talawanda.org

Outdoor Adventure Club

The Outdoor Adventure Club is a series of field trips on the 3rd Wed. of each month in cooperation with Miami University's Outdoor Pursuit Center. Students learn outdoor skills while participating in unique activities at outdoor sites around Oxford. Registration for trips is done directly through Miami University.

More info, including specific trip destinations, costs, dates, and registration, can be found by accessing the Google Classroom for the club with the course code: rvw303o

Or, by contacting Mr. Hricko at hrickos@talawanda.org"

Craft Club

Open to All TMS Students

Advisors: Cherie Day and Carolyn Ratliff

Meeting Time: Most meetings are held the second Thursday of the month and are announced on the morning and afternoon school announcements.

We plan and complete craft projects according to student interests. Join us for fun and creativity.

TMS Little Aggies

Open to 6-8th grades

Middle School Agricultural Program!

Leadership, agriculture, & fun to be had by all!

Advisor: Mike Derringer, THS FFA teacher

derringer@talawanda.org

Middle School Contact: Steven Hricko

hrickos@talawanda.org

Drama Club

The purpose of the club is to put on an annual school musical.

Advisor: Kelly Case (assisted by Beth Fryer)

casek@talawanda.org

fryerb@talawanda.org

Peer Mediators

We meet Wednesdays during 7th and 8th grade tutorial

Students are being trained in conflict resolution and once they are fully trained, students will be able to help peers who are in conflict to resolve their issues peacefully using compromises and win/win solutions.

Advisor: Laura Jewett

jewettl@talawanda.org

Student Council (elected students)

Scheduled Meetings - Friday's after school

Gather student input hosts events, raise money, etc... to benefit TMS

Advisor: John Brinck

brinckj@talawanda.org

Mathcounts Competition Team

A national middle school coaching and competitive mathematics program that promotes mathematics achievement through a series of fun and engaging "bee" style contests. The program provides engaging math programs to U.S. middle school students of all ability levels in order to build confidence and improve attitudes towards math and problem solving.

Advisor: Lori Gloeckner gloecknerl@talawanda.org

National Junior Honor Society (NJHS)

NJHS is a group for 8th graders that are selected to become members at the end of 7th grade. Members are selected based on academics (3.75 or above cumulative GPA for all of 6th grade and the first two trimesters of 7th grade), community service involvement, leadership, and character. The chapter has meetings during the regular school day and participates in many school and community initiatives.

For 6th and 7th graders interested in becoming members as 8th graders: keep your grades up, take on leadership roles at school and in other activities, keep your behavior and actions in good conduct, and perform community service!

Megan Murray, Advisor

murraym@talawanda.org

Guitar Club (The Shredi Knights)

We learn how to practice, maintain and improve musical theory understanding and guitar upkeep. We also just do some jamming together to get used to playing with other musicians live!

Advisor: Raj Sundram

sundramr@talawanda.org

Writer's Club

Advisor: Cheri Day

dayc@talawanda.org

Talawanda Diversity Club

Introducing the new Talawanda Middle School Diversity Club! We are interested in spreading appreciation of the differences that every student brings to TMS, and celebrating what makes each one of us unique. We will explore what we can do at school and in our greater community to help our place be safe and inclusive for all students.

Advisor: Amy Clay

claya@talawanda.org